

# PLATFORM

Inspection - Converting - Finishing

The PLATFORM family of products establishes a new level of converting and finishing capabilities built around an in-line modular design.

Beginning with a 30-inch (762 mm) or 40-inch (1016 mm) diameter unwind complete with hydraulic roll lifting system, a typical PLATFORM machine incorporates a horizontal web inspection section which accommodates stroboscopes, 100% vision inspection systems and electronic flag/millsplice or matrix/missing label detection systems. Defects are positioned to a fault editing position with integrated diaphragm web clamps for operator review and correction. Various converting modules can be inserted—from a delamination/relamination section for RFID label insertion to laminating, top coating and register diecutting (full-rotary and semi-rotary) modules. Multiple slitting methods such as cartridge shear, scorecut, razor and lineal die, are available depending on the materials being converted. All PLATFORM machines include integrated open-loop unwind and rewind tension controls with closed-loop available for those critical applications. The PLATFORM design also allows for both single or dual rewind shaft configurations. Numerous motor drive technologies are incorporated, depending on the machine configuration, utilizing AC vector, stepper and servomotors where applicable. Active operator controls are located along the length of the PLATFORM machine and a touch screen panel provides an ideal operator interface to set-up and save critical information for each job.

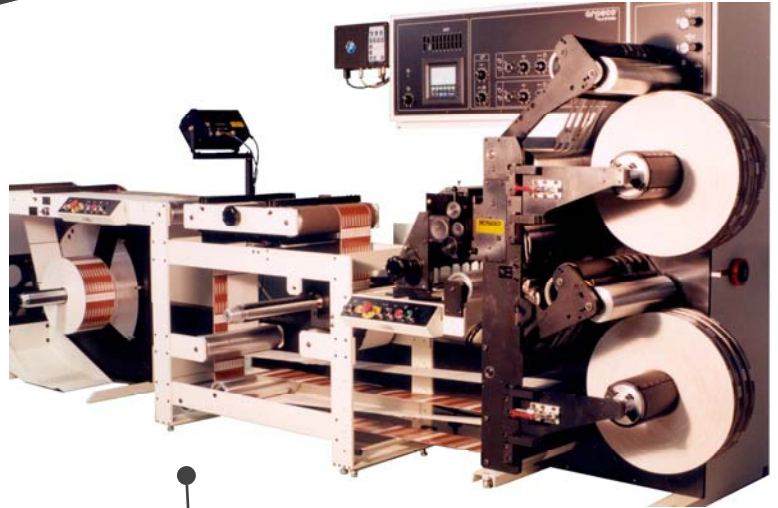

## Specifications

Web Width	330 mm (13") 407 mm (16") 560 mm (22")
Unwind Diameter (Standard)	762 mm (30") 762 mm (30") 1016 mm (40")
Unwind Diameter (Optional)	1016 mm (40") 1016 mm (40") N/A
Maximum Rewind Diameter	457 mm (18") Optional 610 mm (24")
Maximum Speed	260 m/min (850 ft/min)
Unwind/Rewind Shaft Diameter	76 mm (3")
AC Motor Drive	On Application
Electrical	On Application
Air	5-7 bars (80-100 PSI) Nominal Consumption
Dimensions	On Application
Weight	On Application



30 Inch Unwind with Lifter



Dual Rewind



Platform Controls

**arpeco**<sup>®</sup>

A PRECISION AUTOMATION<sup>®</sup> COMPANY

Manufacturing - 1841 Old Cuthbert Road Cherry Hill, NJ USA Phone: 856-428-7400 Fax: 856-428-1270  
International Sales & Service - 7405 East Danbro Crescent Mississauga ON, Canada L5N 6P8  
Phone: 905-812-5150 Fax: 905-812-5171

Visit our website at [www.arpeco.com](http://www.arpeco.com)

# PLATFORM

Inspection - Converting - Finishing

## Available PLATFORM Options:

To handle a wide variety of applications we offer the following options:

- Stroboscopes
- 100% Vision Inspection
- Flag/Millsplice and Matrix Missing Label Detection
- Motor-driven Waste Rewind
- Delamination / Relamination with RFID Insertion
- Coating Station with IR/Hot Air and/or UV Curing
- Register Diecutting Module (full-rotary and semi-rotary)
- Score, Razor and Lineal Die Slitting
- Trim Extraction
- Ironing and Bowed Rollers
- Clear Label Count
- Automatic Closed-loop Tension Control
- Flanged Shafts and Adaptors
- Dynatrac Count & Control System
  - Arpeco Tension Management System (ATMS)
  - Auto-setup Arpeco count sensor with see-through and reflective mark counting capabilities
  - Optimized counter slowdown
  - 100 Job Memory
  - Secure count capability
  - Full Fault Placement
  - Machine Status Messages & Maintenance Log

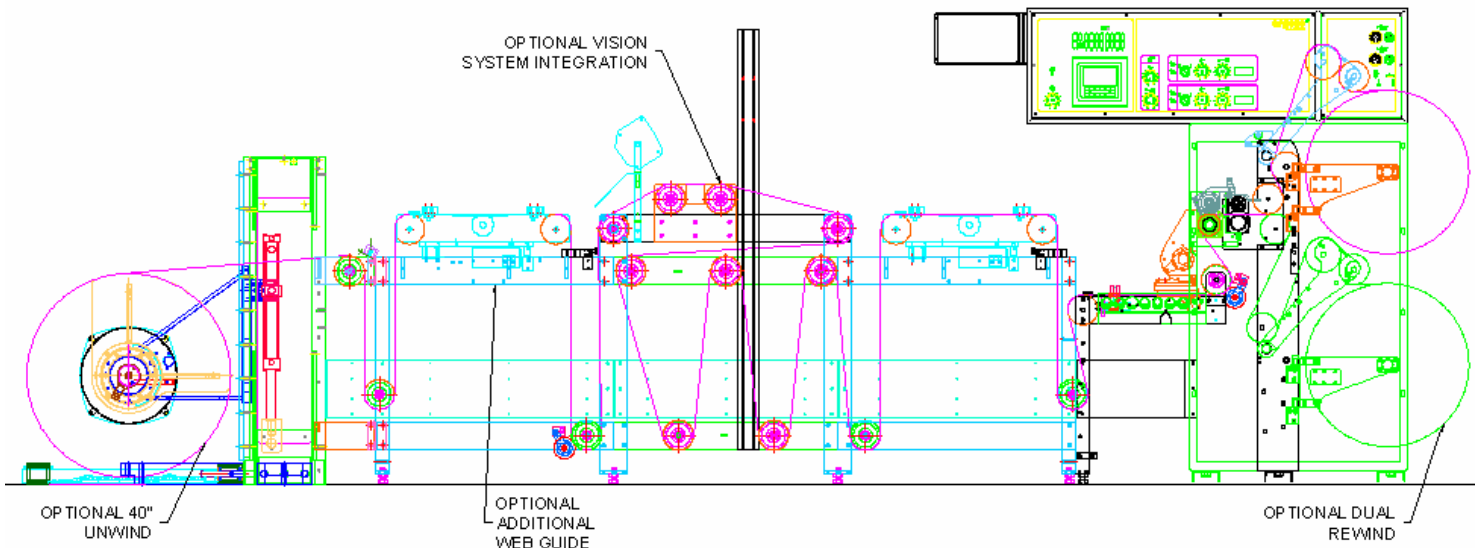

Manufacturing - 1841 Old Cuthbert Road Cherry Hill, NJ USA Phone: 856-428-7400 Fax: 856-428-1270  
International Sales & Service - 7405 East Danbro Crescent Mississauga ON, Canada L5N 6P8  
Phone: 905-812-5150 Fax: 905-812-5171

Visit our website at [www.arpeco.com](http://www.arpeco.com)

**arpeco**<sup>®</sup>  
A PRECISION AUTOMATION<sup>®</sup> COMPANY